

HIGH SPIN HYGIENIC BARRIER WASHER EXTRACTORS

**MXB
RANGE**

MXB360 MXB500 MXB700

36KG 50KG 70KG
80LB 110LB 155LB



FEATURES

- Freestanding, high spin
- Large drain valve 2x Ø 76 mm
- Easy access to all parts
- Frequency controlled motor
- Large door opening for easy loading and unloading.
- XControl Plus
 - Freely programmable
 - Multilingual
- PowerWash® perforated lifting ribs: better washing results, lower water consumption
- Eco washing programs - significantly reduces water and electricity consumption
- Soap dispenser with 5 removable compartments
- Cascade drum
- RS485 & USB plug
- Designed with focus on ergonomoy
- Golden lock - patented inner door lock mechanism

OPTIONS

- Stainless steel cabinet
- Liquid soap pumps
- Opti-load® linen weighing and waterconsumption optimization system
- Trace-Tech® traceability software and networking system
- Isolation for energy and noise reduction
- Version without soap hopper
- Drain valve for water recycling
- Water sample tap
- Second display (located on clean side)
- Lateral drain
- Extra visualization (orange light + horn)
- Extra visualization (traffic light + horn)



GET AHEAD IN LAUNDRY 

| TYPE | | MXB360 | MXB500 | MXB700 |
|---------------------------|-----|-------------------|---|-------------------|
| CAPACITY | | | | |
| Drum volume | l | 360 | 500 | 700 |
| Capacity | kg | 36 | 50 | 70 |
| Drum diameter | | | 775 | |
| Drum depth | mm | 764 | 1060 | 1484 |
| Drum type | | | Cascade | |
| Number of drums | | 1 | 1 | 2 |
| Number of loading doors | | 1 | 1 | 2 |
| Number of unloading doors | | 1 | 1 | 2 |
| MOTOR | | | | |
| Power | kW | 4 | | 7,5 |
| DRUM SPEED | | | | |
| Wash speed | rpm | | 41 | |
| Extraction speed | rpm | | 900 | |
| G-Factor | | | | |
| | | | 350 | |
| PROGRAMMER | | | | |
| XControl Plus | | | standard | |
| CABINET | | | | |
| Door opening angle | | | 155 | |
| HEATING | | | | |
| 100% hot water | °C | | 90 | |
| 100% electrical | kW | 36 | 48 | 60 |
| Steam high pressure | bar | | 3-8 | |
| CONNECTION | | | | |
| Electrical | | | 3x 200-240V 50/60Hz 3x 380-415V 50/60Hz 3x 440-480V 50/60Hz | |
| Water inlet | in | | 3x 1" | |
| Steam inlet | in | | 3/4" | |
| Drain diameter | in | | 2x 3" | |
| DIMENSIONS | | | | |
| H×W×D | mm | 1700 x 1270 x 980 | 1700 x 1566 x 980 | 1700 x 2032 x 980 |
| Net weight | kg | 960 | 1130 | 1310 |
| TRANSPORT DATA | | | | |
| Packed H×W×D | mm | 2005x1530x1255 | 2005x1830x1195 | 2005x2290x1195 |
| Gross weight | kg | 1090 | 1280 | 1470 |

36 / 50 kg

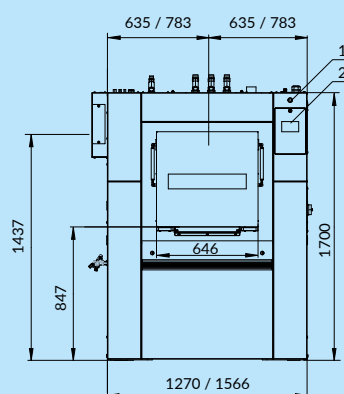

70 kg

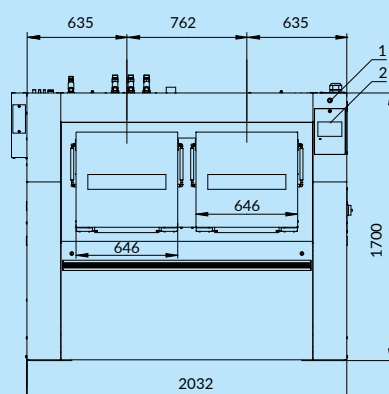

36, 50, 70 kg

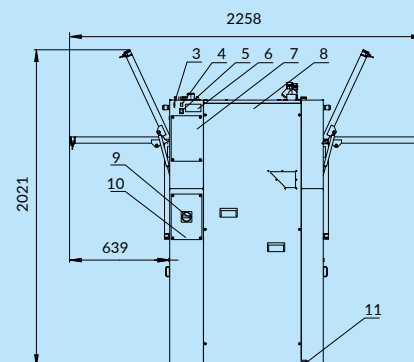

- 1 Emergency stop
- 2 Control panel
- 3 USB Port
- 4 PC Programming Connection

- 5 Switch: Steam / Electric Heating
- 6 Serial Plate
- 7 Electrical Signals Liquid Soap Cover
- 8 Electrical Components with Frequency Inverter Cover

- 9 Main Switch Cover
- 10 Main Switch
- 11 Equipotential Bounding Terminal

The Primus preserves the right to change the machines and the specification in this leaflet at any time, without prior notice. Details and photographs are only for information and never binding.

www.primuslaundry.com

Primus by Alliance Laundry Systems

